

# 4' Dent Saver Bench Inventory List

Top Ends (2)



Feet (2)



Center Supports (2)



Slat Supports (3)



Legs (4)



4-1/4" Dowel (4)



3" Dowel (4)



2-3/4" Dowel (12)



1-1/8" Dowel (12)

Slats (5)



Front/Back (2)

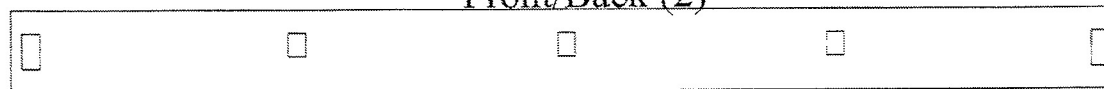

Stringers (2)

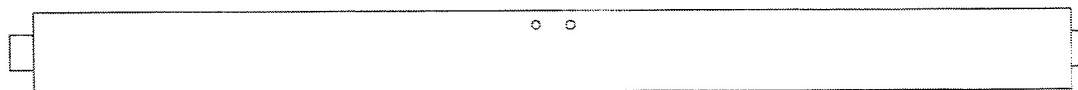

SP-1613

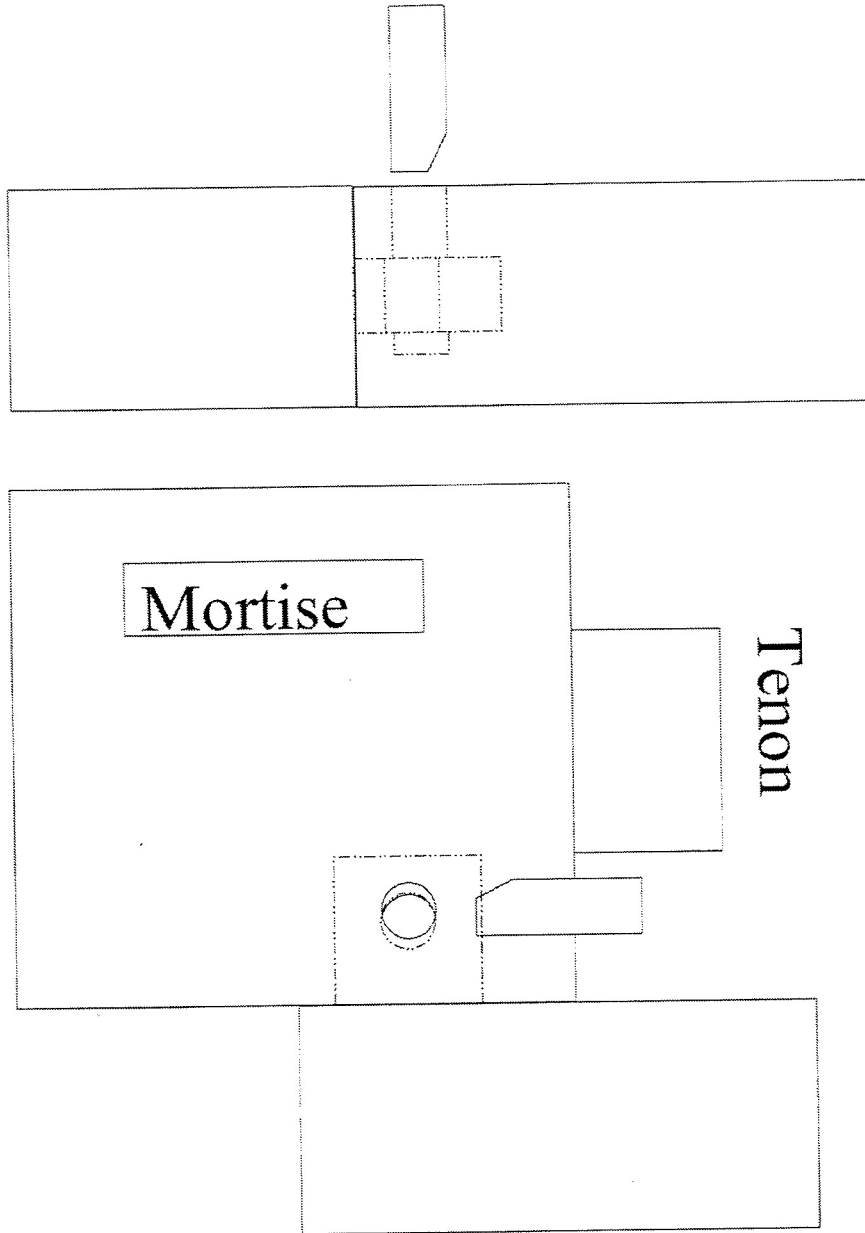

Durawood Aisle-Maker benches are fastened together using a combination of dowel rods and mortise and tenon joints. A mortise is a rectangular hole cut into the Durawood, and a tenon is the cut down end that sticks out from the piece of Durawood. The Durawood material is very strong; however, the tenons can be broken or crushed if care is not taken during assembly. In order to obtain a tight rigid bench the joints are made to be a tight fit and must be forced together either by pressing or tapping with a hammer (ensure to use pad).

The enclosed dowels (except the 3" dowels) have a tapered end and a flat end. The tapered end of the dowel is used to draw the tenon tight into the mortise, therefore it must be inserted properly. If you look into a dowel hole in a mortised piece that has a tenon inserted into it, you can see that the hole in the tenon does not align with the hole in the mortise (see illustration). This is to draw the tenon tight into the mortise, therefore the dowel must be aligned in such a way as to draw the tenon into the mortise. After the dowel is aligned properly it is hammered flush with the Durawood surface (except the 4-1/4" dowels and the 3" dowels which protrude approximately 1-1/2" when fully inserted).

1.

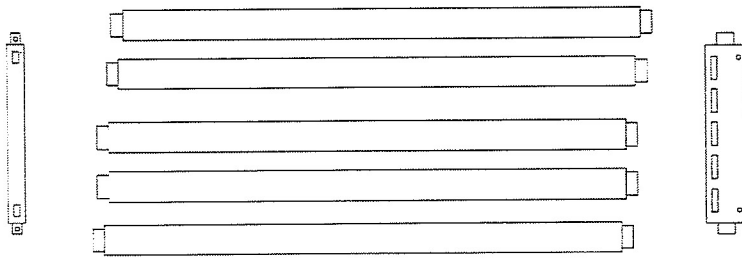

1. Locate the five slats and two top ends. Place one of the ends on the floor (make sure there is carpet or cardboard under it to prevent scratches) and insert the tenon of a slat into the mortises of the bench top end. Repeat for all five slats.

2.

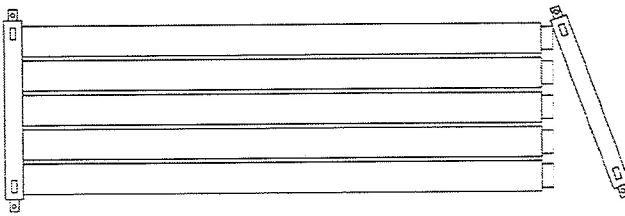

2. Orient the other end so the mortises are lined up the same as the end on the floor and starting from one end push the tenons on the slats into the mortises on the end piece. Keep the end at an angle as you guide each slat in then push down until the next slat is ready to be inserted.

3.

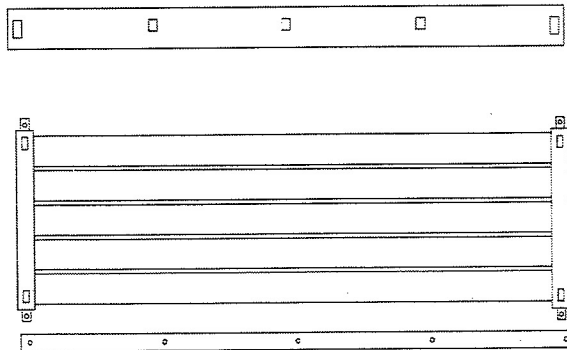

3. Locate the front and back pieces. Orient the pieces so that the mortices are facing the slat assembly and the drilled holes are facing up. Insert the tenons from the top ends into the mortises in the front piece.

4.

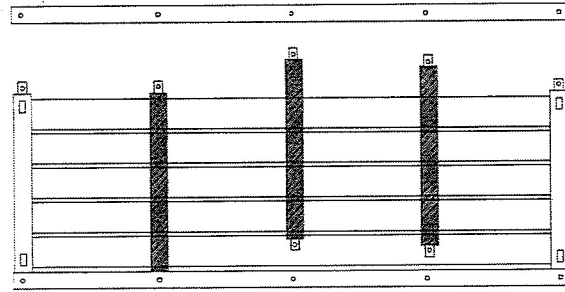

4. Locate the three slat supports and orient them with the cut side AWAY from the slats (cut side is highlighted in grey). Insert the tenons on the slat supports into each of the three mortises on the front piece.

5.

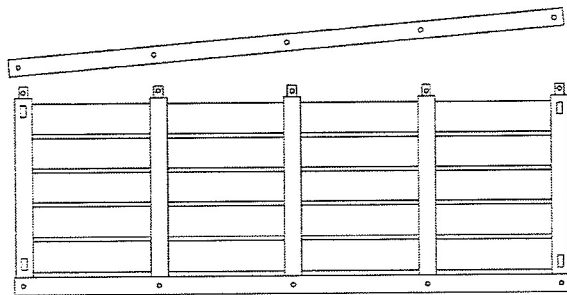

5. Orient the back piece with the mortises toward the tenons on the slat assembly and the drilled holes facing up. Insert the tenons into the back piece one at a time using a hammer and the hammer pad to fully seat the tenons into the mortises.

6.

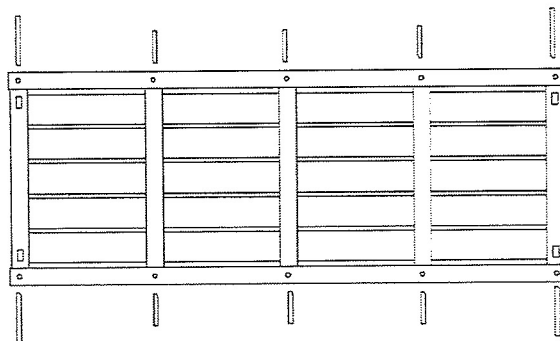

6. Find six 2-3/4" long nylon dowels and insert them into the six holes (refer to the dowel insertion guide to orient them correctly) that connect the slat supports to the front and back pieces. After the dowels are aligned use a hammer to drive the dowels in flush with the surface of the board.

Now locate four 4-1/4" nylon dowels and insert them into the four corners to connect the top ends to the front and back pieces. When fully seated approximately 1-1/2" of the dowel will protrude.

7.

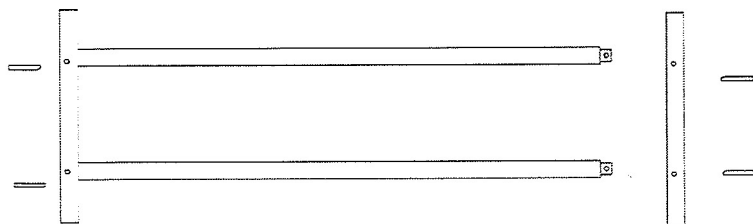

7. Locate the two feet and the two stringers and orient the stringers with the mortise holes facing down and the feet with the mortise facing the stringer tenon and the side with two drilled holes (no mortises) facing up. Slide the feet onto the stringers and lock them in place with four 2-3/4" nylon dowels.

8.

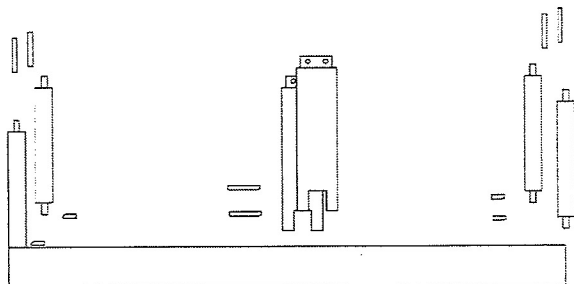

8. Set the stringer assembly aside and go to the top assembly and place it top side down. Get the four legs and two center supports. Position the fork of the center supports over the center slat support and lock them in place using two 2-3/4" nylon dowels. Now take each of the four legs and slide them onto each of the four dowels protruding from the corners of the top assembly. Ensure the tenons on the legs align with the mortises on the top ends prior to tapping them into place (CAUTION: DO NOT HAMMER ON THE PROTRUDING TENON TO SEAT THE LEGS, USE THE FLAT SURFACE OF THE LEG END TO TAP ON). Now lock the four legs into place using four 1-1/8" dowels. Insert a 3" dowel into the holes on the exposed ends of each of the four legs.

9.

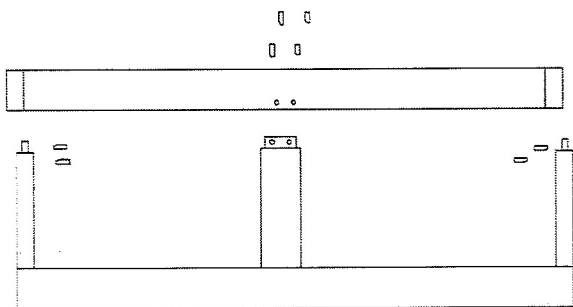

9. Now retrieve the stringer assembly and carefully place it on the tenons (using the dowels in the legs for alignment) of the legs and center supports. Use a hammer and a non marring pad to tap the tenons into place. Now use four 1-1/8" nylon dowels to lock the center supports to the stringer and four 1-1/8" dowels to lock the legs to the feet.

10.

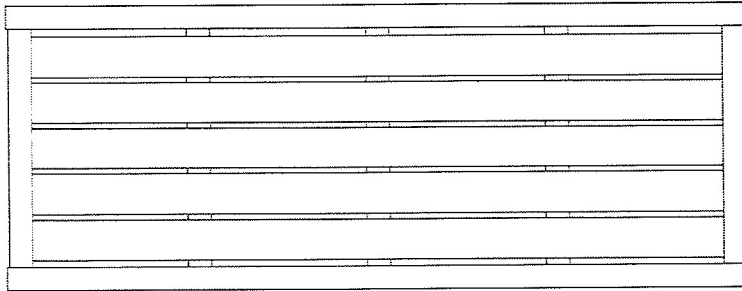

TOP VIEW

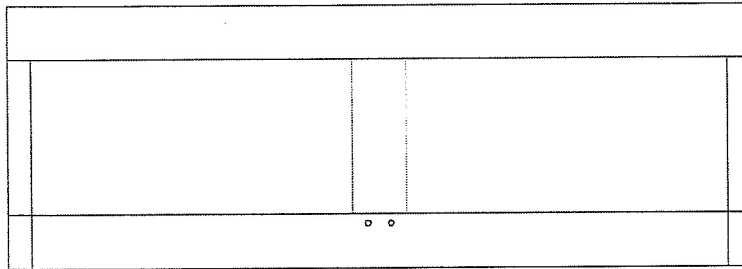

FRONT VIEW

**10.** The bench is now completely assembled. If it looks funny, that is because it is up-side-down, flip it over and it is ready to use.

If your bench does not look like the one illustrated in figure 10, or if you have any other questions call us at 800-927-8303 or Email - [ORDERS@WESBAM.COM](mailto:ORDERS@WESBAM.COM)

and ask for assistance in bench assembly. Before you call, yes we put extra dowels in the kit so they are extras not missed ones.

SP-1613